



HUGO & BORG

C A B I N E T M A K E R S

YOUR HOME - YOUR STYLE

THE QUALITY CABINETRY PEOPLE

We call ourselves cabinet makers, but at Hugo&Borg we like to think we do more than just make cabinets, we make kitchen dreams come true. Our exciting, ready-to-install collection has it all — and it's all exclusively available at Lowe's.



QUICK SHIP

We'll ship within 21 days from ordering. That's less than half the industry's standard lead-time.



LIMITED LIFETIME WARRANTY

Great quality and durability guaranteed — we make our cabinets and doors to last.



INCREDIBLE VALUE

Everything about Hugo&Borg says quality. It's unusual to find this level of specification and value combined in one brand.



NEED DESIGN HELP?

Don't have time for an in-store appointment?

Want to design from your home?

Connect with our Hugo&Borg design team for our free design service:

Email: info@hugoandborg.com

Phone: 1.833.748.HUGO (4846)



ONLINE QUICK ESTIMATE TOOL

Our easy-to-use online quick estimate tool makes it fast and fun to visualize your new kitchen. We'll even give you a quick quote!



EXCEPTIONAL SERVICE

Our friendly, knowledgeable team knows our kitchens inside out. We're here to help every step of the way.



LET'S MAKE IT HAPPEN

Start browsing our stunning kitchens on the following pages — you're sure to find the perfect one for you!

WE MAKE KITCHEN DESIGN EASY

We like to keep things simple at Hugo&Borg. Our kitchen collection offers a choice of extremely well-considered designs, in just the right combination of cabinet types and size options, so you can visualize your dream kitchen layout with ease.

Here's our most popular layouts — which one is right for you? Or for something a bit different ask our Hugo&Borg design expert.



STRAIGHT

For maximum use of every square inch in small spaces, a one-wall layout keeps everything close to hand.

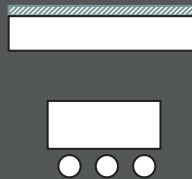

STRAIGHT - ISLAND

A highly modern, sociable layout, great for open plan living, this gives you more food preparation space without compromising style.

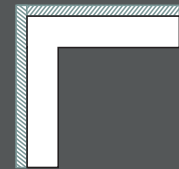

L - SHAPE

A popular layout that makes light work of the 'working triangle' between sink, range and refrigerator. The open floor area allows plenty of room for multiple cooks.

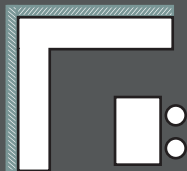

L - SHAPE ISLAND

This winning layout is both practical and sociable. There's plenty of work surface area and you can entertain while you cook!

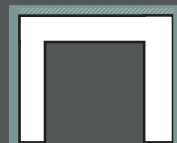

U - SHAPE

The mighty U-shape gives wall-to-wall cabinetry for maximum storage space and work area. A more closed-in layout, check your window position will let in plenty of light.

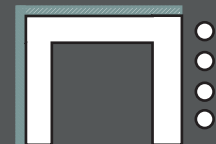

U - SHAPE PENINSULA

The best of both worlds and ideal for open plan living; enjoy plenty of storage space and work area in a more sociable layout.

Start today to visualize what your kitchen will look like.

Or if you prefer to leave it to the experts, just email our Hugo&Borg team direct and we'll create a design for you — it's all part of the service.

1 CHOOSE



2 DESIGN



3 SAVE



4 EMAIL



Quick-click menu - choose layout, measurements, door styles, handles, etc.

On screen reminder of your choices

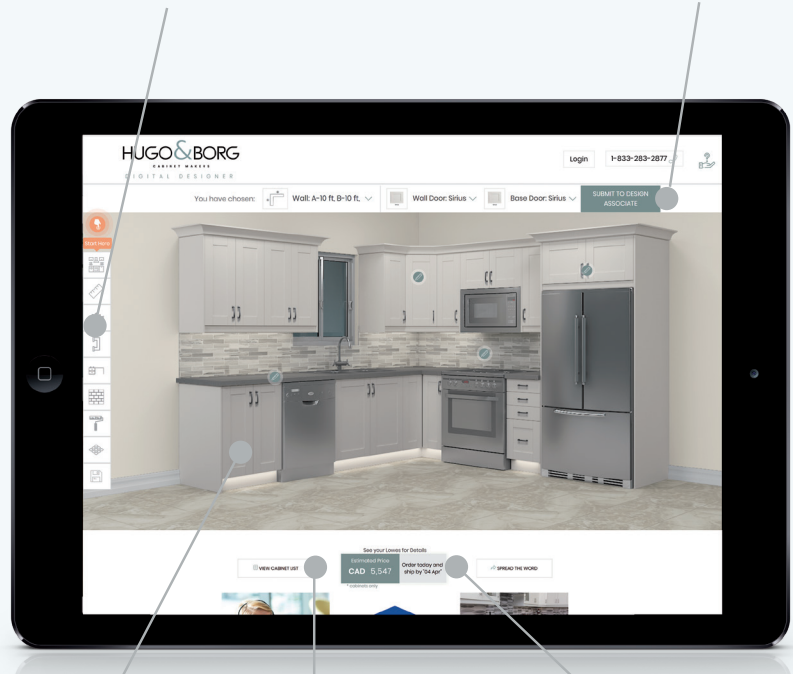

See the image change instantly

Cabinet order list is automatically generated

Immediate price and shipping date estimates

ONLINE

hugoandborg.com/digital-designer/

EMAIL

info@hugoandborg.com

PHONE

1.833.748.HUGO (4846)



COLLECTIONS

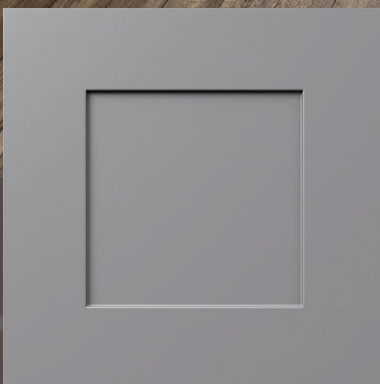

BEAUMONT

Distinctively rich, this classic premium-painted slate gray shaker style effortlessly radiates a refined warmth and beauty.





Always in style, this creamy premium-painted warm white shaker design creates an inviting cozy space.

JOLIE



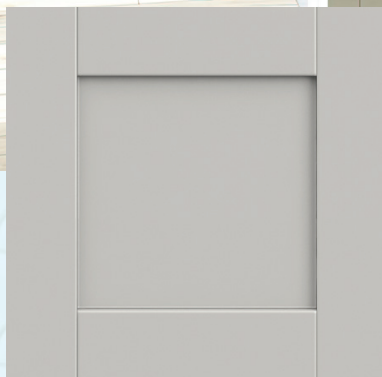

Soft and sophisticated, this light gray shaker design is sure to make a style statement and be loved for years to come.

CHARLESBERG

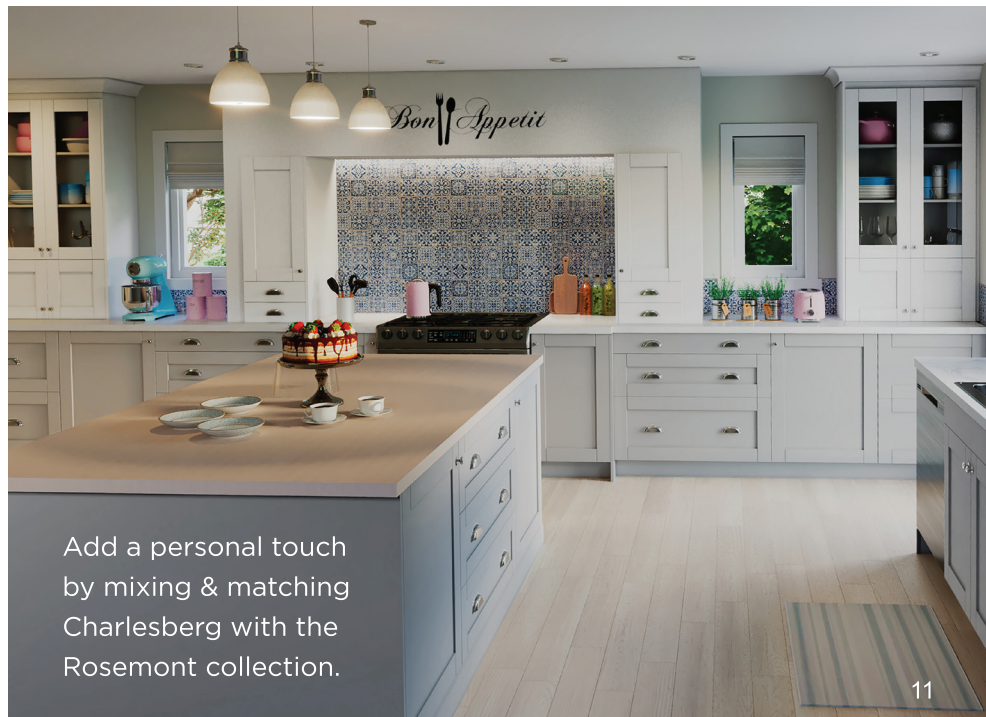

Add a personal touch
by mixing & matching
Charlesberg with the
Rosemont collection.

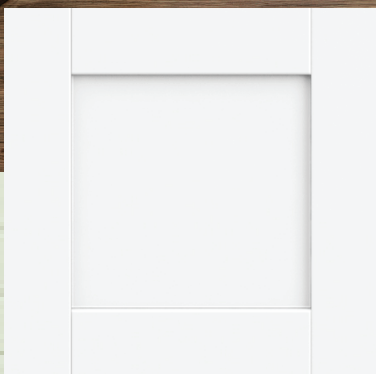

ROSEMONT

Timeless and elegant, it's easy to contrast or coordinate with this simple, glacier white shaker style to create a fresh and bright space.

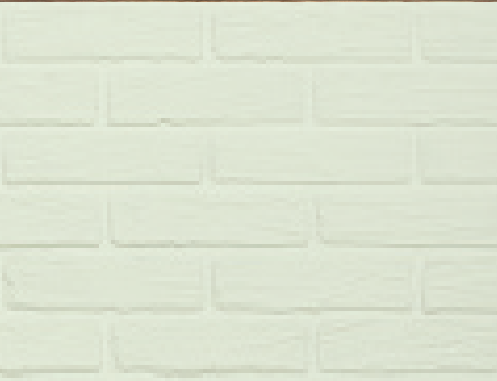

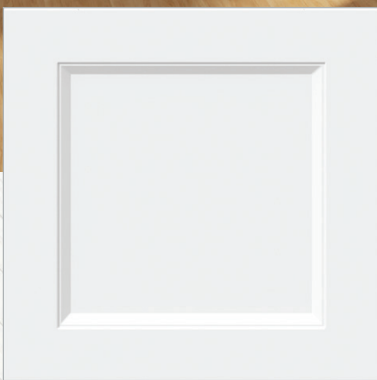

RIVIERA

Riviera is a classic and timeless bright white shaker door. It's fully versatile and coordinates easily with both neutrals and bold colors.



LORETTE

A versatile navy door that can add bold depth or serene calm. Lorette mixes perfectly with our bright white Riviera style.



Jolie

CABINETS FOR THE WHOLE HOME

It's easy to combine Hugo&Borg cabinets to create functional and beautiful storage for your whole home: the mudroom, entertaining spaces, office, laundry room, bathroom and more!

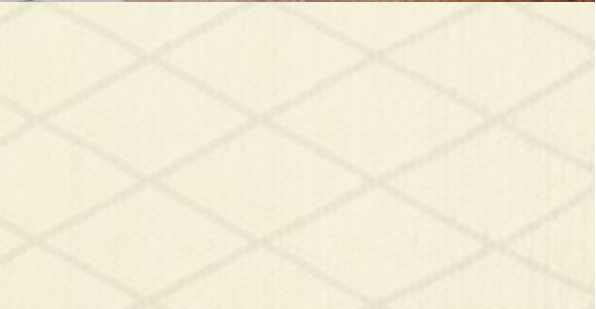



Charlesberg and Rosemont

CREATE A CUSTOM LOOK

Combining door styles adds a dynamic and polished look to every space. Not only does this add visual interest, but opens your décor color palette even more! Get creative and have fun with your styles!



Beaumont and Jolie

SUPERIOR CONSTRUCTION

High quality is our standard - at a price everyone can afford.

THE DIFFERENCE IS IN THE DETAILS

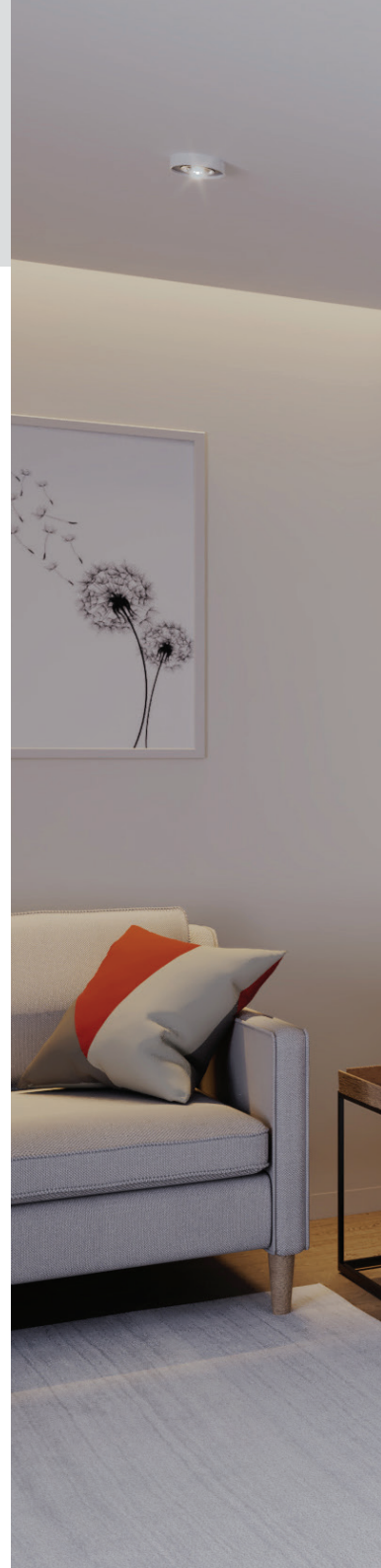
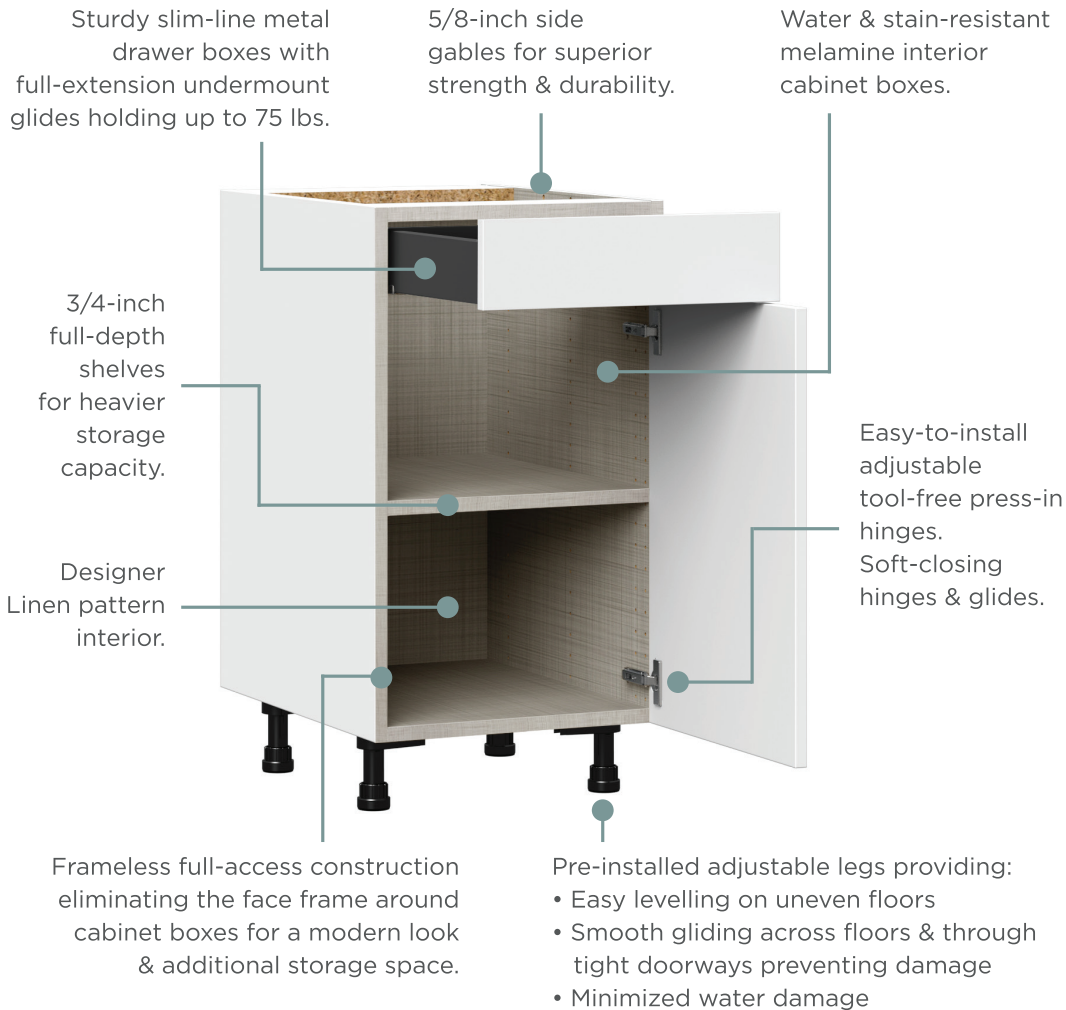



DOORS & DRAWER FRONTS

Here's our door styles at a glance. Each style comes in a wide choice of door and drawer sizes and are available separately so you can create your ideal layout. **Ask in store or visit hugoandborg.com for more details.**



BEAUMONT

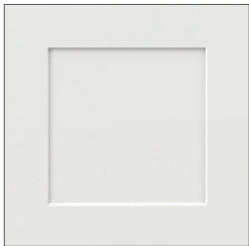

JOLIE



CHARLESBERG

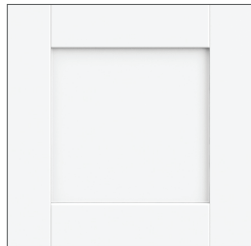

ROSEMONT

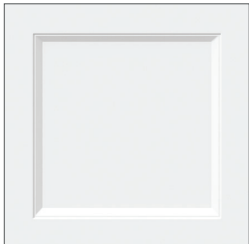

RIVIERA



LORETTE

DOOR FRONTS (W X D X H)

12 x 3/4 x 10"	12 x 3/4 x 25"	9 x 3/4 x 35"
13 1/2 x 3/4 x 10"	13 1/2 x 3/4 x 25"	12 x 3/4 x 35"
15 x 3/4 x 10"	15 x 3/4 x 25"	13 1/8 x 3/4 x 35"
16 1/2 x 3/4 x 10"	16 1/2 x 3/4 x 25"	13 1/2 x 3/4 x 35"
18 x 3/4 x 10"	18 x 3/4 x 25"	15 x 3/4 x 35"
12 x 3/4 x 15"	21 x 3/4 x 25"	16 1/2 x 3/4 x 35"
13 1/2 x 3/4 x 15"	24 x 3/4 x 25"	18 x 3/4 x 35"
15 x 3/4 x 15"	9 x 3/4 x 30"	21 x 3/4 x 35"
16 1/2 x 3/4 x 15"	11 x 3/4 x 30"	24 x 3/4 x 35"
18 x 3/4 x 15"	12 x 3/4 x 30"	
12 x 3/4 x 20"	13-1/8 x 3/4 x 30"	
13 1/2 x 3/4 x 20"	13 1/2 x 3/4 x 30"	
15 x 3/4 x 20"	15 x 3/4 x 30"	
16 1/2 x 3/4 x 20"	16 1/2 x 3/4 x 30"	
18 x 3/4 x 20"	18 x 3/4 x 30"	
21 x 3/4 x 20"	21 x 3/4 x 30"	
24 x 3/4 x 20"	24 x 3/4 x 30"	

DRAWER FRONTS (W X D X H)

12 x 3/4 x 5"	12 x 3/4 x 15"
15 x 3/4 x 5"	15 x 3/4 x 15"
18 x 3/4 x 5"	18 x 3/4 x 15"
21 x 3/4 x 5"	21 x 3/4 x 15"
24 x 3/4 x 5"	24 x 3/4 x 15"
27 x 3/4 x 5"	27 x 3/4 x 15"
30 x 3/4 x 5"	30 x 3/4 x 15"
33 x 3/4 x 5"	33 x 3/4 x 15"
36 x 3/4 x 5"	36 x 3/4 x 15"
12 x 3/4 x 10"	
15 x 3/4 x 10"	
18 x 3/4 x 10"	
21 x 3/4 x 10"	
24 x 3/4 x 10"	
27 x 3/4 x 10"	
30 x 3/4 x 10"	
33 x 3/4 x 10"	
36 x 3/4 x 10"	

GLASS DOOR FRONTS (W X D X H)

13 1/8 x 3/4 x 30"
13 1/8 x 3/4 x 35"
15 x 3/4 x 30"
15 x 3/4 x 35"
18 x 3/4 x 30"
18 x 3/4 x 35"

All glass doors include clear tempered glass with matching frames

BASE CABINET OPTIONS

Choose from our extensive collection of base cabinets available in all the shapes and sizes you need.
These cabinets are 34 1/2" high including legs x 24" deep. Width options are listed with each cabinet.

BASE CABINETS ➤

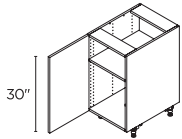

1 DOOR

9" | B9FH(L/R)
12" | B12FH(L/R)
15" | B15FH(L/R)
18" | B18FH(L/R)
21" | B21FH(L/R)
24" | B24FH(L/R)

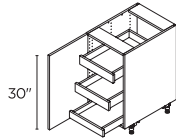

1 DOOR / 3 INNER DRAWERS

15" | B15FHI3(L/R)
18" | B18FHI3(L/R)
21" | B21FHI3(L/R)
24" | B24FHI3(L/R)

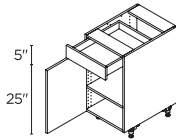

1 DOOR / 1 DRAWER

12" | B12(L/R)
15" | B15(L/R)
18" | B18(L/R)
21" | B21(L/R)
24" | B24(L/R)

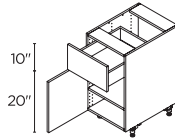

1 DOOR / 1 DRAWER

12" | B12A(L/R)
15" | B15A(L/R)
18" | B18A(L/R)
21" | B21A(L/R)
24" | B24A(L/R)

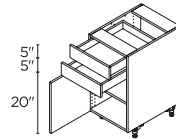

1 DOOR / 2 DRAWERS

12" | B12B(L/R)
15" | B15B(L/R)
18" | B18B(L/R)
21" | B21B(L/R)
24" | B24B(L/R)

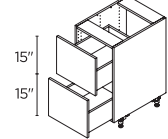

2 DRAWERS

12" | B2D12 27" | B2D27
15" | B2D15 30" | B2D30
18" | B2D18 33" | B2D33
21" | B2D21 36" | B2D36
24" | B2D24

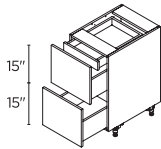

2 DRAWERS / 1 INNER DRAWER

12" | B2D12I1 27" | B2D27I1
15" | B2D15I1 30" | B2D30I1
18" | B2D18I1 33" | B2D33I1
21" | B2D21I1 36" | B2D36I1
24" | B2D24I1

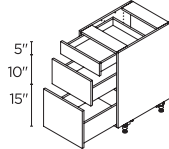

3 DRAWERS

12" | B3D12 27" | B3D27
15" | B3D15 30" | B3D30
18" | B3D18 33" | B3D33
21" | B3D21 36" | B3D36
24" | B3D24

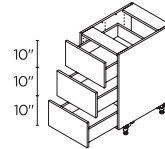

3 DRAWERS

12" | B3DA12 27" | B3DA27
15" | B3DA15 30" | B3DA30
18" | B3DA18 33" | B3DA33
21" | B3DA21 36" | B3DA36
24" | B3DA24

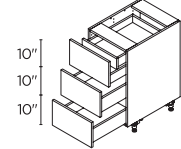

3 DRAWERS / 1 INNER DRAWER

12" | B3DA12I1 27" | B3DA27I1
15" | B3DA15I1 30" | B3DA30I1
18" | B3DA18I1 33" | B3DA33I1
21" | B3DA21I1 36" | B3DA36I1
24" | B3DA24I1

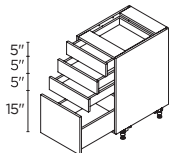

4 DRAWERS

12" | B4D12 27" | B4D27
15" | B4D15 30" | B4D30
18" | B4D18 33" | B4D33
21" | B4D21 36" | B4D36
24" | B4D24

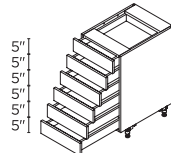

6 DRAWERS

12" | B6D12 27" | B6D27
15" | B6D15 30" | B6D30
18" | B6D18 33" | B6D33
21" | B6D21 36" | B6D36
24" | B6D24

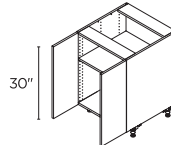

2 DOORS

24" | B24-2FH
27" | B27FH
30" | B30FH
33" | B33FH
36" | B36FH

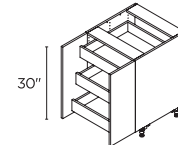

2 DOORS / 3 INNER DRAWERS

24" | B24-2FHI3
27" | B27FHI3
30" | B30FHI3
33" | B33FHI3
36" | B36FHI3

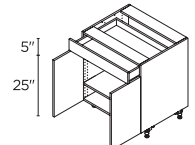

2 DOORS / 1 DRAWER

27" | B27
30" | B30
33" | B33
36" | B36

BASE CABINETS

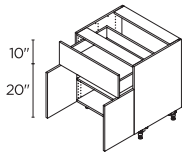

2 DOORS / 1 DRAWER

27" | B27A
30" | B30A
33" | B33A
36" | B36A

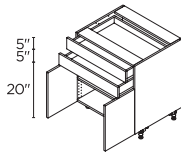

2 DOORS / 2 DRAWERS

27" | B27B
30" | B30B
33" | B33B
36" | B36B

CORNER CABINETS

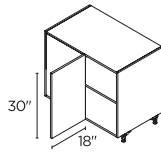

BLIND CORNER WITH SHELF

39" | BBCL39
39" | BBCR39

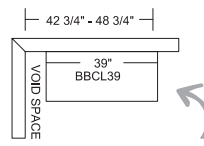

*Min. 42 3/4" doesn't allow
for filler / hardware clearance.
Max. 48 3/4" is with 6" filler
attached to be flush with door
- filler not included.*

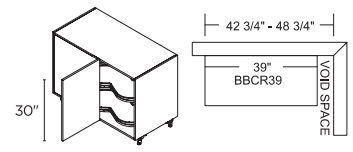

BLIND CORNER WITH PULL-OUT

39" | BBCL39LC
39" | BBCR39LC

CORNER CABINETS

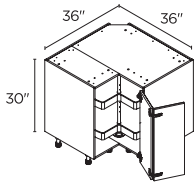

CORNER WITH LAZY SUSAN

36" | BC36LS(L/R)

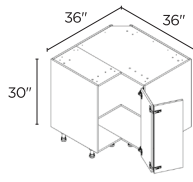

CORNER WITH SHELF

36" | BC36(L/R)

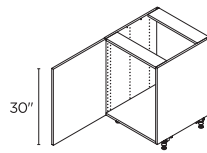

1 DOOR

24" | SB24FH(L/R)

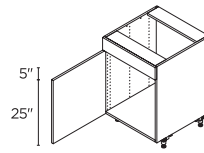

1 DOOR / 1 FIXED FRONT

24" | SB24FF(L/R)

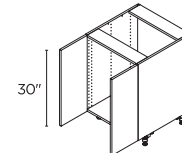

2 DOORS

24" | SB24-2FH
27" | SB27FH
30" | SB30FH
33" | SB33FH
36" | SB36FH

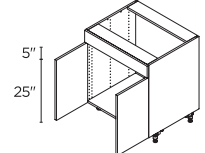

2 DOORS / 1 FIXED FRONT

27" | SB27FF
30" | SB30FF
33" | SB33FF
36" | SB36FF

FARM SINK CABINETS

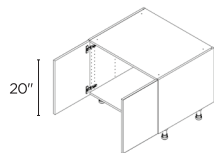

2 DOORS

30" | SBAS30

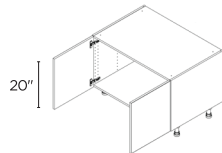

2 DOORS

36" | SBAS36

*A separate drawer front must be
ordered to complete.*

MICROWAVE CABINET

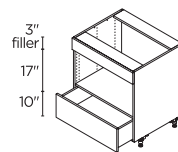

1 DRAWER

30" | BMW30

*Cut-out size:
28 1/2" wide x 17" high.
Filler can be cut to adjust
height opening 17" to 20".*

COOKTOP CABINETS

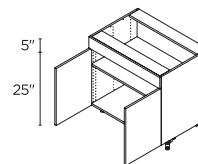

2 DOORS / 1 FIXED FRONT

36" | BCT36FF

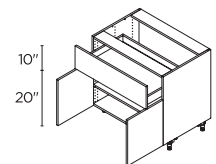

2 DOORS / 1 DRAWER

36" | BCT36A

COOKTOP CABINETS >

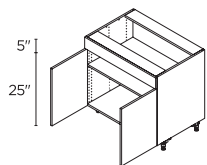

**2 DOORS /
1 FIXED FRONT**
36" | BCT36FF

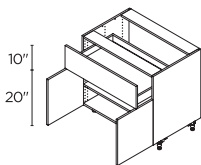

**2 DOORS /
1 DRAWER**
36" | BCT36A

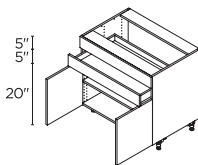

**2 DOORS /
1 DRAWER /
1 FIXED FRONT**
36" | BCT36BFF

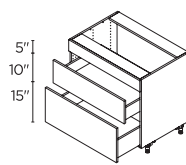

**2 DRAWERS /
1 FIXED FRONT**
36" | BCT3D36FF

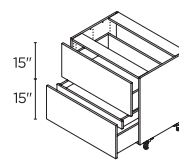

**2 DRAWERS /
1 INNER DRAWER**
36" | BCT2D36II

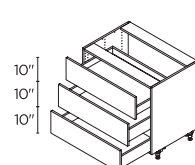

3 DRAWERS
36" | BCT3D36A

COOKTOP CABINETS ✓

WASTE/RECYCLE CABINETS ✓

BASE WINDOW SEAT ✓

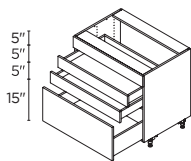

**3 DRAWERS /
1 FIXED FRONT**
36" | BCT4D36FF

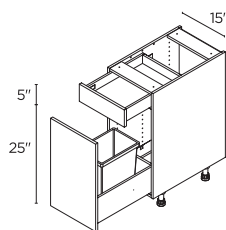

15" | BPO15

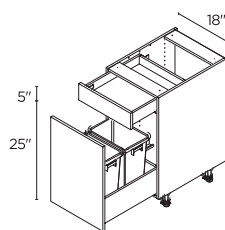

18" | BPO18

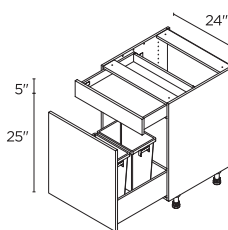

24" | BPO24

PULL-OUT / 1 DRAWER

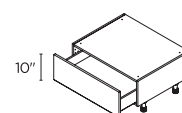

1 DRAWER
30" | BWS3010
36" | BWS3610

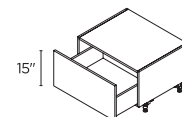

1 DRAWER
30" | BWS3015
36" | BWS3615

SHALLOW BASE CABINET OPTIONS

Choose from our extensive collection of shallow base cabinets available in all the shapes and sizes you need.

These cabinets are 34 1/2" high including legs x 14" deep. Width options are listed with each cabinet.

SHALLOW BASE CABINETS >

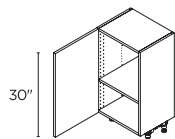

1 DOOR
9" | B914FH(L/R)
12" | B1214FH(L/R)
15" | B1514FH(L/R)
18" | B1814FH(L/R)
21" | B2114FH(L/R)
24" | B2414FH(L/R)

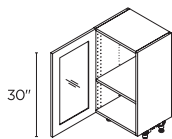

1 GLASS DOOR*
15" | BG1514FH(L/R)
18" | BG1814FH(L/R)

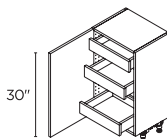

**1 DOOR / 3 INNER
DRAWERS**
12" | B1214FHI3(L/R)
15" | B1514FHI3(L/R)
18" | B1814FHI3(L/R)
21" | B2114FHI3(L/R)
24" | B2414FHI3(L/R)

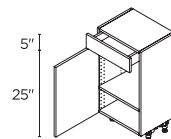

**1 DOOR /
1 DRAWER**
15" | B1514(L/R)
18" | B1814(L/R)
24" | B2414(L/R)

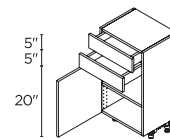

**1 DOOR /
2 DRAWERS**
15" | B1514B(L/R)
18" | B1814B(L/R)
24" | B2414B(L/R)

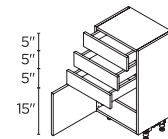

**1 DOOR /
3 DRAWERS**
15" | B1514C(L/R)
18" | B1814C(L/R)

*Glass shelves can be purchased separately.

SHALLOW BASE CABINETS >

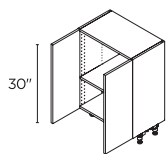

2 DOORS

24" | B2414-2FH
27" | B2714FH
30" | B3014FH
33" | B3314FH
36" | B3614FH

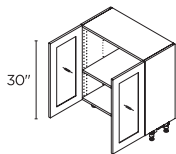

2 GLASS DOORS*

30" | BG3014FH
36" | BG3614FH

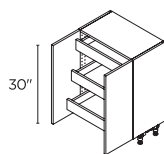

2 DOORS / 3 INNER DRAWERS

24" | B2414-2FHI3
27" | B2714FHI3
33" | B3314FHI3

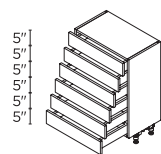

6 DRAWERS

15" | B6D1514
18" | B6D1814
24" | B6D2414

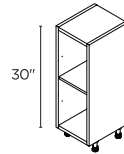

BASE OPEN SHELF

9" | BOS930

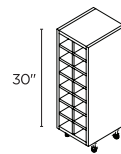

BASE WINE RACK

9" | BWR930

WALL CABINET OPTIONS

Choose from our extensive collection of wall cabinets available in all the shapes and sizes you need.

Our wall and glass door wall cabinets are 14" deep while our deep and corner wall cabinets are 24" deep.

Height and width options are listed with each cabinet.

WALL CABINETS >

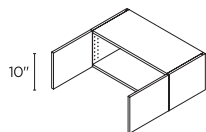

10" HIGH 2 DOORS

27" | W2710
30" | W3010
33" | W3310
36" | W3610

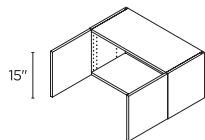

15" HIGH 2 DOORS

27" | W2715
30" | W3015
33" | W3315
36" | W3615

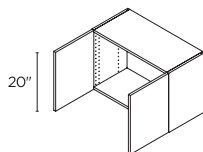

20" HIGH 2 DOORS

27" | W2720
30" | W3020
33" | W3320
36" | W3620

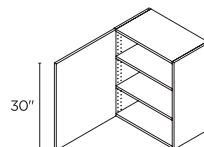

30" HIGH 1 DOOR

9" | W930(L/R) 18" | W1830(L/R)
12" | W1230(L/R) 21" | W2130(L/R)
15" | W1530(L/R) 24" | W2430(L/R)

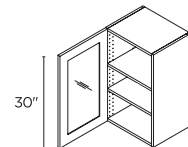

30" HIGH 1 GLASS DOOR*

15" | WG1530(L/R)
18" | WG1830(L/R)

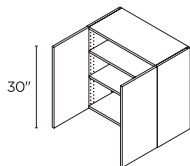

30" HIGH 2 DOORS

24" | W2430-2
27" | W2730
30" | W3030
33" | W3330
36" | W3630

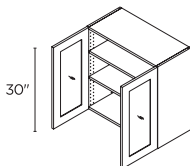

30" HIGH 2 GLASS DOORS*

30" | WG3030
36" | WG3630

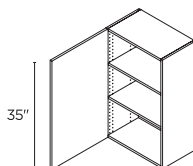

35" HIGH 1 DOOR

9" | W935(L/R) 21" | W2135(L/R)
12" | W1235(L/R) 24" | W2435(L/R)
15" | W1535(L/R) 27" | W2735(L/R)
18" | W1835(L/R) 33" | W3335(L/R)

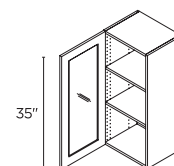

35" HIGH 1 GLASS DOOR*

15" | WG1535(L/R)
18" | WG1835(L/R)

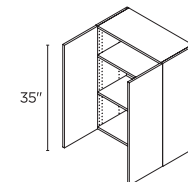

35" HIGH 2 DOORS

24" | W2435-2
27" | W2735
30" | W3035
33" | W3335
36" | W3635

WALL CABINETS >

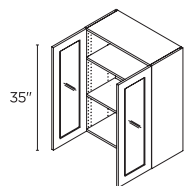

35" HIGH
2 GLASS DOORS*
 30" | WG3035
 36" | WG3635

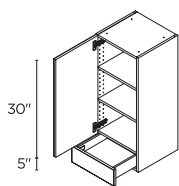

35" HIGH
1 DOOR / 1 DRAWER
 15" | W1535A(L/R)
 18" | W1835A(L/R)
 24" | W2435A(L/R)

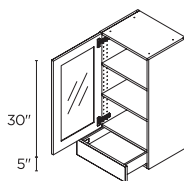

35" HIGH
1 GLASS DOOR* / 1 DRAWER
 15" | WG1535A(L/R)
 18" | WG1835A(L/R)

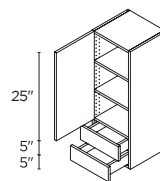

35" HIGH
1 DOOR / 2 DRAWERS
 15" | W1535B(L/R)
 18" | W1835B(L/R)
 24" | W2435B(L/R)

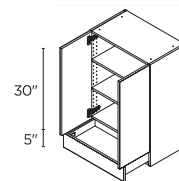

35" HIGH
2 DOORS /
1 DRAWER
 24" | W2435-2B

LIFT-UP WALL CABINETS >

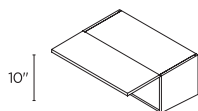

10" HIGH
1 LIFT-UP DOOR
 24" | WLU2410
 27" | WLU2710
 30" | WLU3010
 33" | WLU3310
 36" | WLU3610

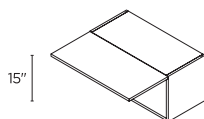

15" HIGH
1 LIFT-UP DOOR
 24" | WLU2415
 27" | WLU2715
 30" | WLU3015
 33" | WLU3315
 36" | WLU3615

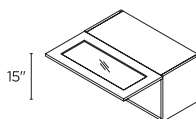

15" HIGH
1 GLASS LIFT-UP DOOR
 30" | WLUG3015

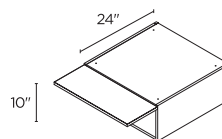

10" HIGH
1 LIFT-UP DOOR
 24" | WLU241024
 27" | WLU271024
 30" | WLU301024
 33" | WLU331024
 36" | WLU361024

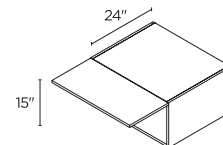

15" HIGH
1 LIFT-UP DOOR
 24" | WLU241524
 27" | WLU271524
 30" | WLU301524
 33" | WLU331524
 36" | WLU361524

DEEP WALL CABINETS >

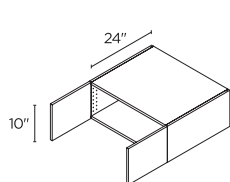

10" HIGH
2 DOORS
 27" | W271024
 30" | W301024
 33" | W331024
 36" | W361024

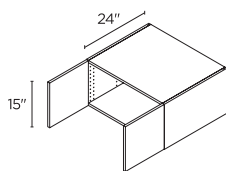

15" HIGH
2 DOORS
 27" | W271524
 30" | W301524
 33" | W331524
 36" | W361524

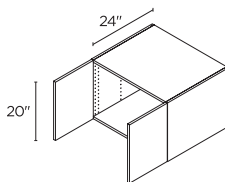

20" HIGH
2 DOORS
 24" | W242024-2
 27" | W272024
 30" | W302024
 33" | W332024
 36" | W362024

WALL MICROWAVE SHELF >

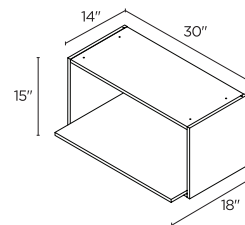

15" HIGH
 30" | WMS3015
Finished interior shelf is removable.

*Glass shelves can be purchased separately.

SPECIALTY WALL CABINETS ✓ CORNER WALL CABINETS ✓

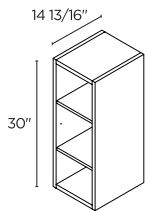

**WALL OPEN
SHELF**
9" | WOS930

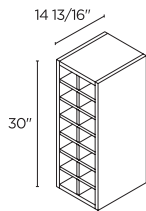

**WALL WINE
RACK**
9" | WWR930 *Vertical or
horizontal
installation.*

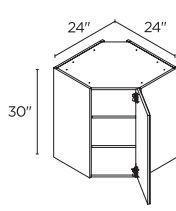

**30" HIGH
1 DOOR**
24" | WA2430(L/R)

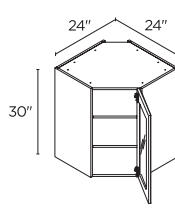

**30" HIGH
1 GLASS DOOR***
24" | WAG2430(L/R)

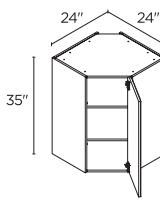

**35" HIGH
1 DOOR**
24" | WA2435(L/R)

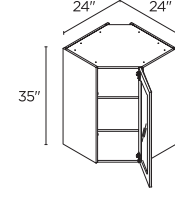

**35" HIGH
1 GLASS DOOR***
24" | WAG2435(L/R)

BLIND CORNER WALL CABINETS ➤

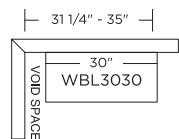
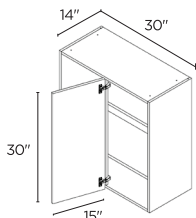

**30" HIGH
1 DOOR**
30" | WBL3030
30" | WBR3030

*Max. 35" is with 6" filler
attached to be flush with door -
filler not included.*
*Panel next to door is white for all
collections. Filler is required.*

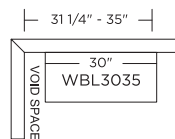
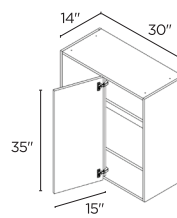

**35" HIGH
1 DOOR**
35" | WBL3035
33" | WBR3035

84 1/2" H TALL CABINET OPTIONS

Choose from our extensive collection of tall cabinets available in all the shapes and sizes you need.
These cabinets are 24" deep x 84 1/2" high. Width options are listed with each cabinet.

84 1/2" H TALL APPLIANCE CABINETS ➤

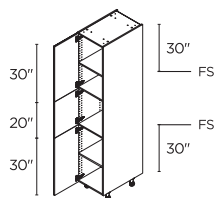

3 DOORS
15" | T152484.5(L/R)
18" | T182484.5(L/R)
24" | T242484.5(L/R)

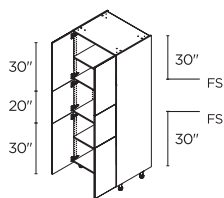

6 DOORS
30" | T302484.5

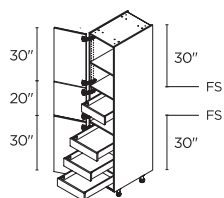

**3 DOORS / 4 INNER
DRAWERS**
15" | T152484.514(L/R)
18" | T182484.514(L/R)
24" | T242484.514(L/R)

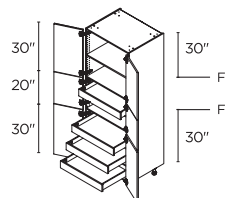

**6 DOORS / 4 INNER
DRAWERS**
30" | T302484.514

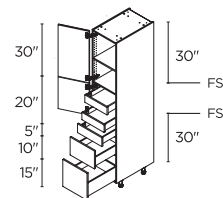

**2 DOORS / 3 DRAWERS
/ 2 INNER DRAWERS**
15" | T3D152484.512(L/R)
18" | T3D182484.512(L/R)
24" | T3D242484.512(L/R)

RS = Reinforced Shelf. FS = Fixed Shelf. **Appliance cut-out sizes:** (use of a filler is required and must be ordered separately): ¹ 28 1/2" width x 18 1/2" high. ² 28 1/2" width x 43 1/2" high. ³ 28 1/2" width x 53 1/2" high. ⁴ 28 1/2" width x 28 1/2" high.

**Glass shelves can be purchased separately.*

84 1/2" H TALL APPLIANCE CABINETS ➤

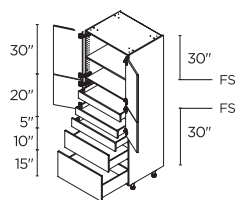

**4 DOORS / 3 DRAWERS
/ 2 INNER DRAWERS**

30" | T3D302484.5I2

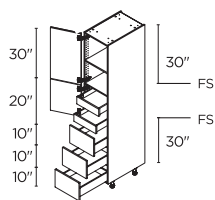

**2 DOORS / 3 DRAWERS
/ 2 INNER DRAWERS**

15" | T3DA152484.5I2(L/R)
18" | T3DA182484.5I2(L/R)
24" | T3DA242484.5I2(L/R)

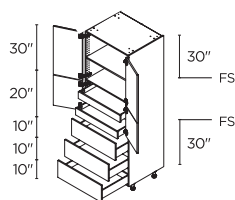

**4 DOORS / 3 DRAWERS
/ 2 INNER DRAWERS**

30" | T3DA302484.5I2

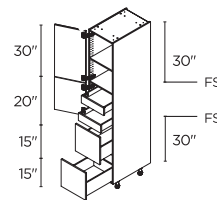

**2 DOORS / 2 DRAWERS
/ 2 INNER DRAWERS**

15" | T2D152484.5I2(L/R)
18" | T2D182484.5I2(L/R)
24" | T2D242484.5I2(L/R)

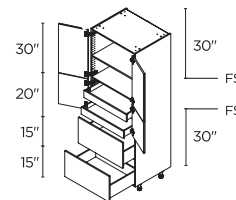

**4 DOORS / 2 DRAWERS
/ 2 INNER DRAWERS**

30" | T2D302484.5I2

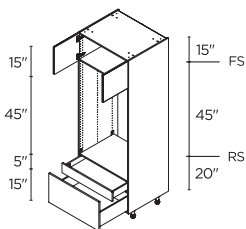

**MICRO/WALL OVEN ²
2 DOORS /
2 DRAWERS**

30" | TMO2D3084.5

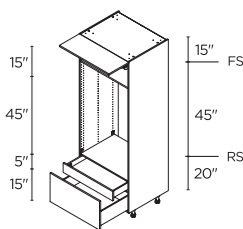

**MICRO/WALL OVEN ²
1 LIFT-UP DOOR /
2 DRAWERS**

30" | TMOL2D3084.5

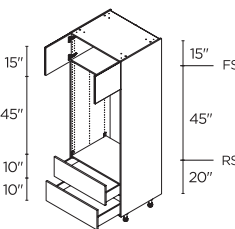

**MICRO/WALL OVEN ²
2 DOORS /
2 DRAWERS**

30" | TMO2DA3084.5

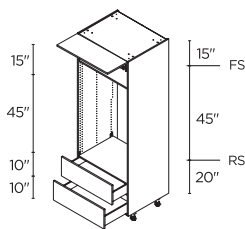

**MICRO/WALL OVEN ²
1 LIFT-UP DOOR /
2 DRAWERS**

30" | TMOL2DA3084.5

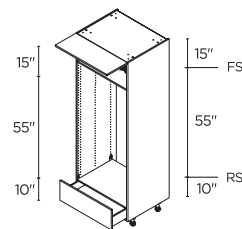

**DOUBLE OVEN ³
1 LIFT-UP DOOR /
1 DRAWER**

30" | TDOLA3084.5

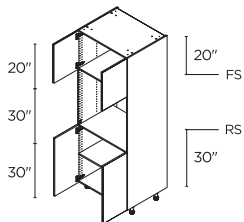

**SINGLE OVEN ⁴
4 DOORS**

30" | TO3084.5

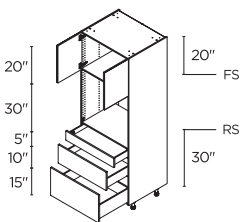

**SINGLE OVEN ⁴
2 DOORS /
3 DRAWERS**

30" | TO3D3084.5

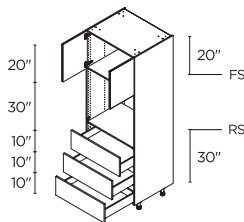

**SINGLE OVEN ⁴
2 DOORS /
3 DRAWERS**

30" | TO3DA3084.5

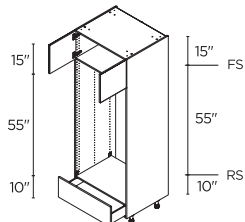

**DOUBLE OVEN ³
2 DOORS / 1 DRAWER**

30" | TDOA3084.5

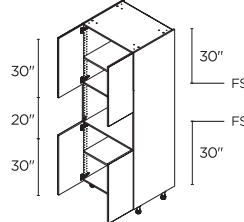

**MICROWAVE ¹
4 DOORS**

30" | TM3084.5

RS = Reinforced Shelf, FS = Fixed Shelf. **Appliance cut-out sizes:** (use of a filler is required and must be ordered separately):

¹28 1/2" width x 18 1/2" high. ²28 1/2" width x 43 1/2" high. ³28 1/2" width x 53 1/2" high. ⁴28 1/2" width x 28 1/2" high.

84 1/2" H TALL APPLIANCE CABINETS >

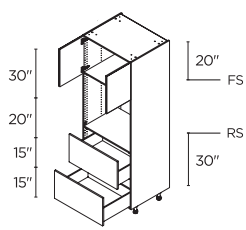

MICROWAVE ¹
2 DOORS /
2 DRAWERS
 30" | TM2D3084.5

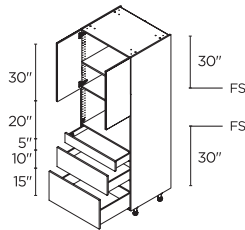

MICROWAVE ¹
2 DOORS /
3 DRAWERS
 30" | TM3D3084.5

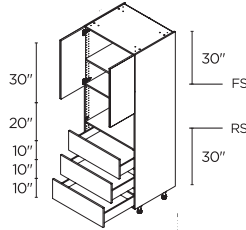

MICROWAVE ¹
2 DOORS /
3 DRAWERS
 30" | TM3DA3084.5

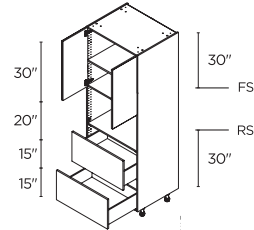

MICROWAVE ¹
2 DOORS /
2 DRAWERS
 30" | TM2D3084.5

89 1/2" H TALL CABINET OPTIONS

Choose from our extensive collection of tall cabinets available in all the shapes and sizes you need.

These cabinets are 24" deep x 89 1/2" high. Width options are listed with each cabinet.

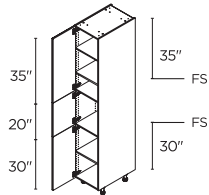

3 DOORS
 15" | T152489.5(L/R)
 18" | T182489.5(L/R)
 24" | T242489.5(L/R)

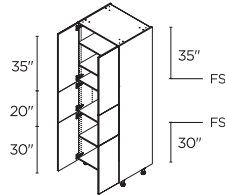

6 DOORS
 30" | T302489.5

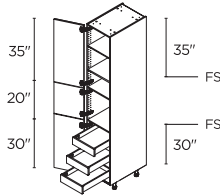

**3 DOORS / 3 INNER
 DRAWERS**
 15" | T152489.513(L/R)
 18" | T182489.513(L/R)
 24" | T242489.513(L/R)

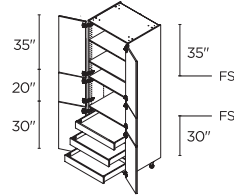

**6 DOORS / 3 INNER
 DRAWERS**
 30" | T302489.513

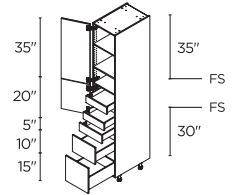

**2 DOORS / 3 DRAWERS
 / 2 INNER DRAWERS**
 15" | T3D152489.512(L/R)
 18" | T3D182489.512(L/R)
 24" | T3D242489.512(L/R)

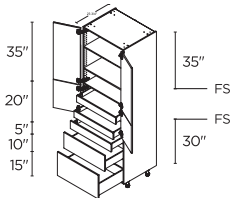

**4 DOORS / 3 DRAWERS
 / 2 INNER DRAWERS**
 30" | T3D302489.512

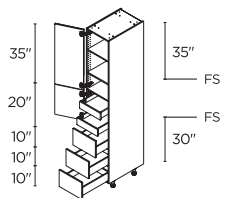

**2 DOORS / 3 DRAWERS
 / 2 INNER DRAWERS**
 15" | T3DA152489.512(L/R)
 18" | T3DA182489.512(L/R)
 24" | T3DA242489.512(L/R)

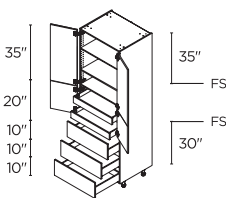

**4 DOORS / 3 DRAWERS
 / 2 INNER DRAWERS**
 30" | T3DA302489.512

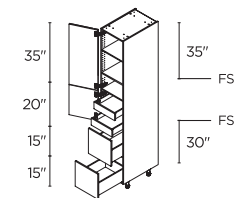

**2 DOORS / 2 DRAWERS
 / 2 INNER DRAWERS**
 15" | T2D152489.512(L/R)
 18" | T2D182489.512(L/R)
 24" | T2D242489.512(L/R)

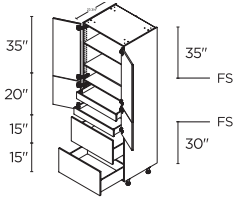

**4 DOORS / 2 DRAWERS
 / 2 INNER DRAWERS**
 30" | T2D302489.512

RS = Reinforced Shelf. FS = Fixed Shelf. **Appliance cut-out sizes:** (use of a filler is required and must be ordered separately):

¹ 28 1/2" width x 18 1/2" high. ² 28 1/2" width x 43 1/2" high. ³ 28 1/2" width x 53 1/2" high. ⁴ 28 1/2" width x 28 1/2" high.

89 1/2" H TALL APPLIANCE CABINETS ➤

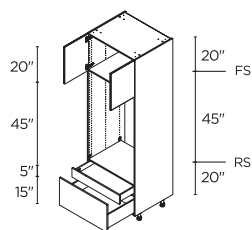

MICRO/WALL OVEN ²
2 DOORS / 2 DRAWERS
 30" | TMO2D3089.5

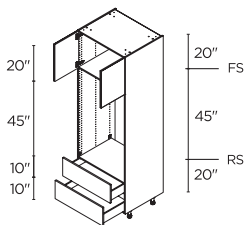

MICRO/WALL OVEN ²
2 DOORS / 2 DRAWERS
 30" | TMO2DA3089.5

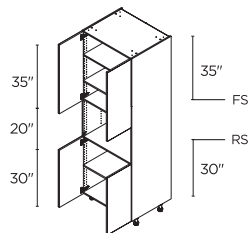

MICROWAVE ¹
4 DOORS
 30" | TM3089.5

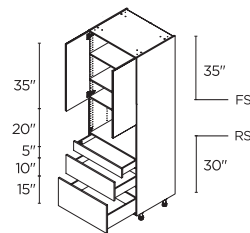

MICROWAVE ¹
2 DOORS / 3 DRAWERS
 30" | TM3D3089.5

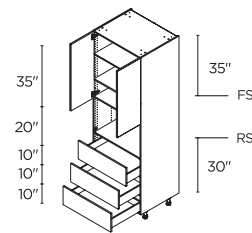

MICROWAVE ¹
2 DOORS / 3 DRAWERS
 30" | TM3DA3089.5

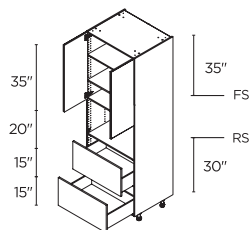

MICROWAVE ¹
2 DOORS / 2 DRAWERS
 30" | TM2D3089.5

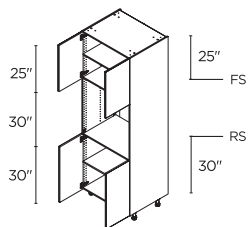

SINGLE OVEN ³
4 DOORS
 30" | TO3089.5

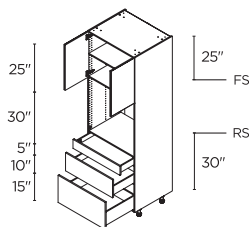

SINGLE OVEN ³
2 DOORS / 3 DRAWERS
 30" | TO3D3089.5

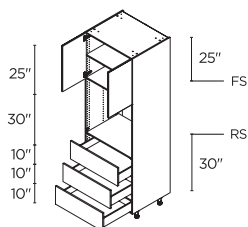

SINGLE OVEN ³
2 DOORS / 3 DRAWERS
 30" | TO3DA3089.5

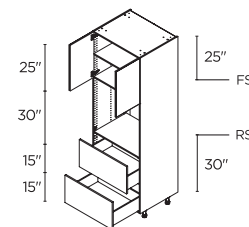

SINGLE OVEN ³
2 DOORS / 2 DRAWERS
 30" | TO2D3089.5

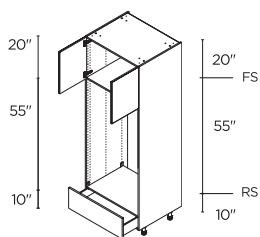

DOUBLE OVEN ³
2 DOORS / 1 DRAWER
 30" | TDOA3089.5



Beaumont

RS = Reinforced Shelf. FS = Fixed Shelf. **Appliance cut-out sizes:** (use of a filler is required and must be ordered separately):
¹ 28 1/2" width x 18 1/2" high. ² 28 1/2" width x 43 1/2" high. ³ 28 1/2" width x 53 1/2" high. ⁴ 28 1/2" width x 28 1/2" high.

VANITY CABINET OPTIONS

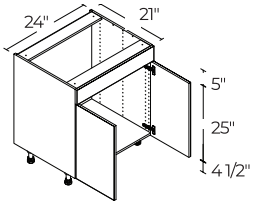

2 DOORS
24" | VS24

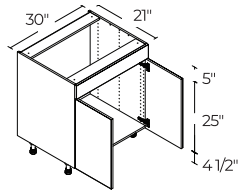

2 DOORS
30" | VS30

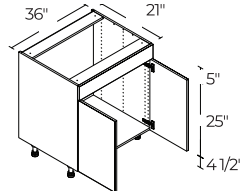

2 DOORS
36" | VS36

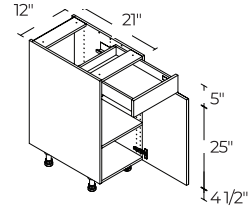

1 DOOR / 1 DRAWER
12" | V12

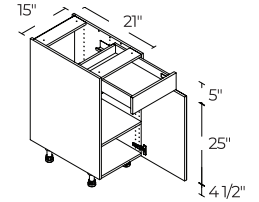

1 DOOR / 1 DRAWER
15" | V15

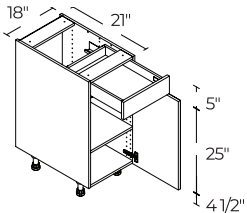

1 DOOR / 1 DRAWER
18" | V18

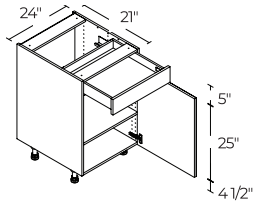

1 DOOR / 1 DRAWER
24" | V24

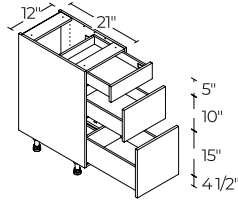

3 DRAWERS
12" | V3D12

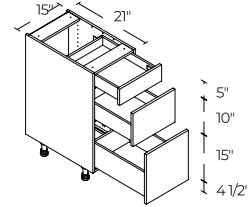

3 DRAWERS
15" | V3D15

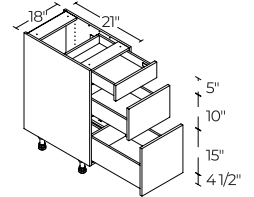

3 DRAWERS
18" | V3D18

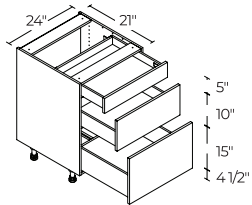

3 DRAWERS
24" | V3D24

ADA KITCHEN CABINET OPTIONS

ADA cabinets will be produced with a white interior.

For ADA cabinets, please order CP1496 to be used as toe kick.

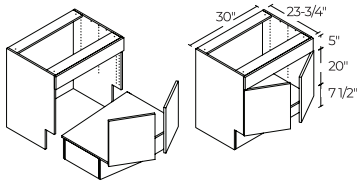

2 DOORS

30" | SB30FFRFADA

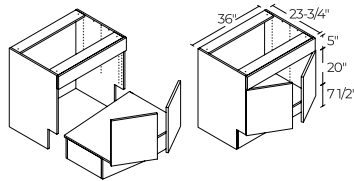

2 DOORS

36" | SB36FFRFADA

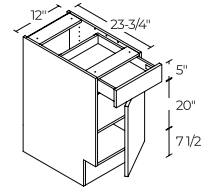

1 DOOR / 1 DRAWER

12" | B12ADA

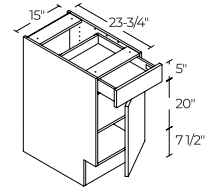

1 DOOR / 1 DRAWER

15" | B15ADA

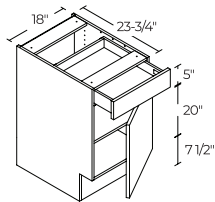

1 DOOR / 1 DRAWER

18" | B18ADA

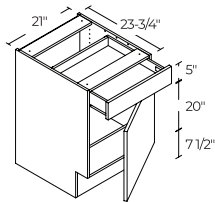

1 DOOR / 1 DRAWER

21" | B21ADA

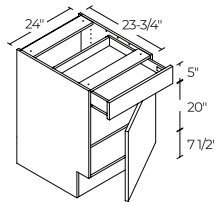

1 DOOR / 1 DRAWER

24" | B24ADA

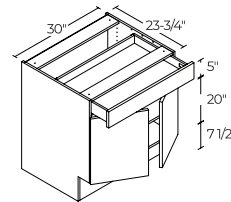

1 DOOR / 1 DRAWER

30" | B30ADA

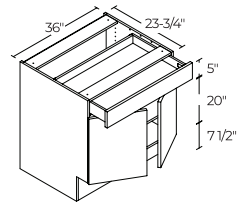

1 DOOR / 1 DRAWER

36" | B36ADA

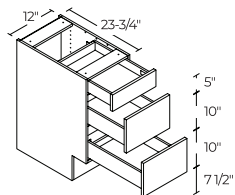

3 DRAWERS

12" | B3D12ADA

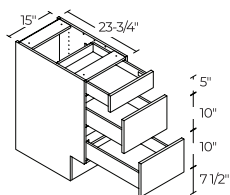

3 DRAWERS

15" | B3D15ADA

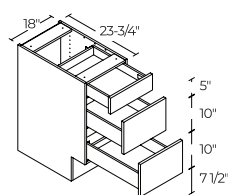

3 DRAWERS

18" | B3D18ADA

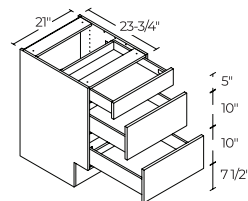

3 DRAWERS

21" | B3D21ADA

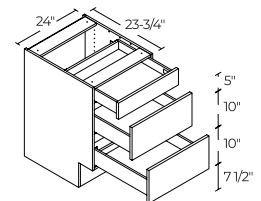

3 DRAWERS

24" | B3D24ADA

ADA VANITY CABINET OPTIONS

ADA cabinets will be produced with a white interior.

For ADA cabinets, please order CP1496 to be used as toe kick.

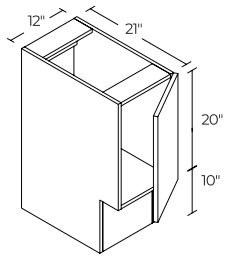

1 DOOR
12" | V12ADA

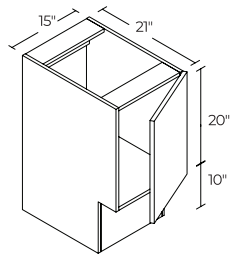

1 DOOR
15" | V15ADA

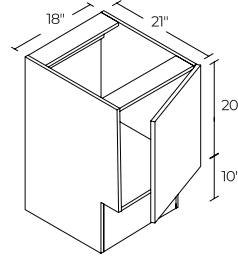

1 DOOR
18" | V18ADA

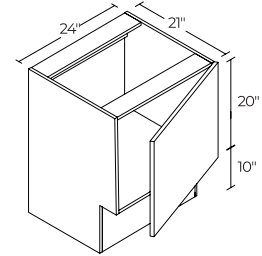

1 DOOR
24" | V24ADA

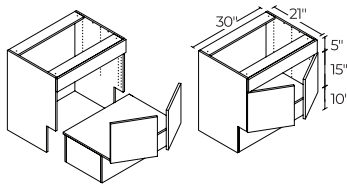

2 DOORS
30" | VS30FFRFADA

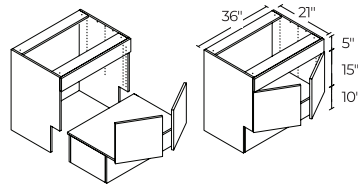

2 DOORS
36" | VS36FFRFADA

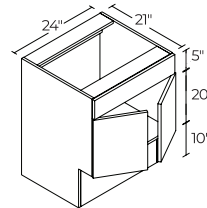

2 DOORS
24" | VS24ADA

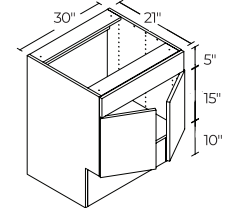

2 DOORS
30" | VS30ADA

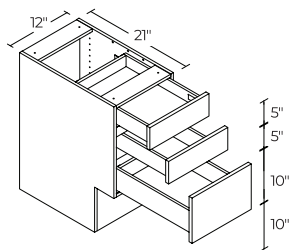

3 DRAWERS
12" | V3D12ADA

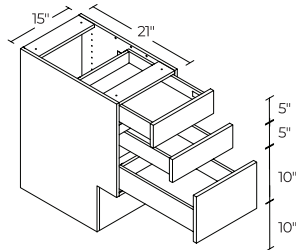

3 DRAWERS
15" | V3D15ADA

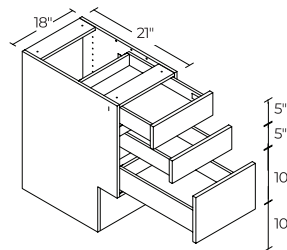

3 DRAWERS
18" | V3D18ADA

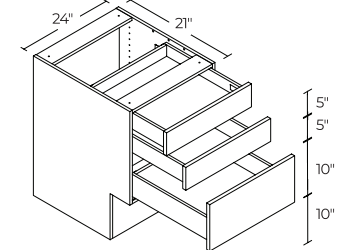

3 DRAWERS
24" | V3D24ADA

FINISHING TOUCHES: COLOR-MATCHED ACCESSORIES

Add stylish finishing touches to your project with our choice of color-matched panels and trims, all designed to complete your kitchen beautifully. All of our cover panels and fillers are finished on both sides and 4 edges.



Cove crown moulding
& glass doors

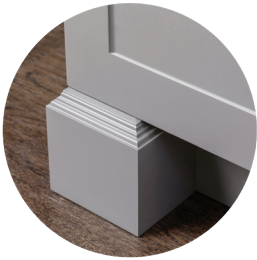

Base moulding



Hidden drawers
/ roll-out trays



Internal glass shelves
/ designer linen interior



Floating shelves

COLOR-MATCHED ACCESSORIES >

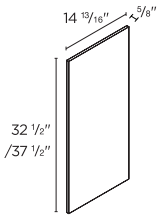

**WALL CABINET
COVER PANEL**
14 13/16"

5/8 x 32 1/2" | CP1432
5/8 x 37 1/2" | CP1437

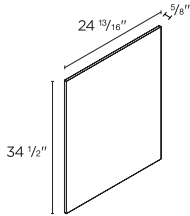

**BASE CABINET
COVER PANEL**
24 13/16"

5/8 x 34 1/2" | CP2434

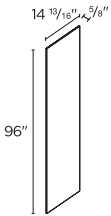

**TALL CABINET
COVER PANEL**
14 13/16"

5/8 x 96" | CP1496

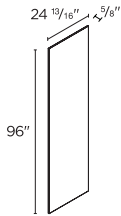

**TALL CABINET
COVER PANEL**
24 13/16"

5/8 x 96" | CP2496

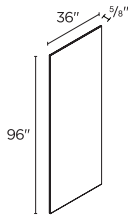

**TALL CABINET
& FRIDGE GABLE
COVER PANEL 36"**

5/8 x 96" | CP3696

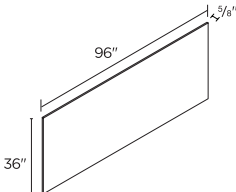

ISLAND PANEL 36"
5/8 x 96" | CP3696

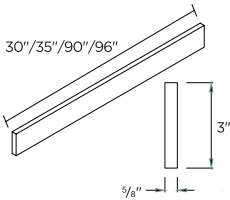

FILLER

3 x 5/8 x 30" | F330
3 x 5/8 x 35" | F335
3 x 5/8 x 96" | F396

ForJolie only:
3 x 5/8 x 90" | F390

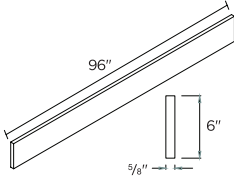

FILLER

6 x 5/8 x 96" | F696

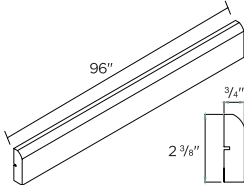

DECORATIVE MOULDING

Available for Beaumont & Jolie only
96 x 2 3/8 x 3/4" | DMC2.596

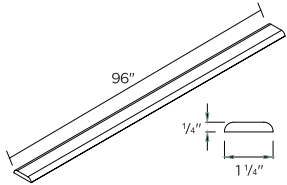

SCRIBE MOULDING

96 x 1/4 x 1 1/4" | SBM96

COLOR-MATCHED ACCESSORIES >

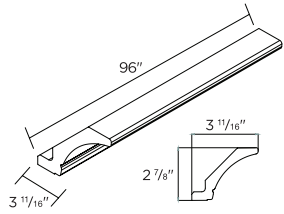

COVE CROWN MOULDING

With integrated cleat
Not available for Savane

96 x 3 11/16 x 2 7/8" | CCM96C

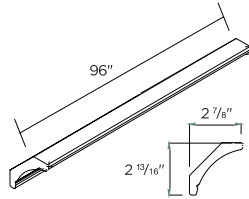

COVE CROWN MOULDING

Without cleat
Not available for Savane

96 x 2 13/16 x 2 7/8" | CCM96NC

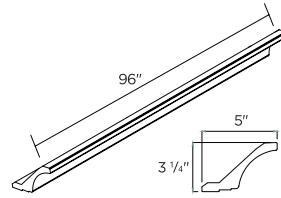

COVE PLAIN CROWN MOULDING

With integrated cleat
Available for Beaumont & Jolie only

96 x 5 x 3 1/4" | CCMP96C

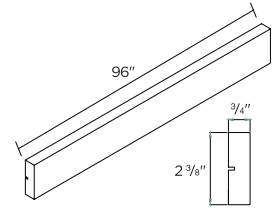

STRAIGHT LIGHT VALANCE MOULDING

96 x 2 3/8 x 3/4" | SLV96

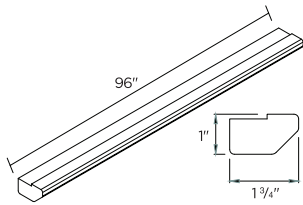

DECORATIVE LIGHT VALANCE MOULDING

Not available for Savane

96 x 1 x 1 3/4" | DLV96

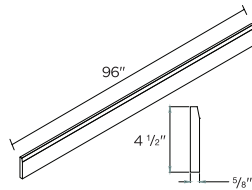

BASE MOULDING

Not available for Savane

96 x 5/8 x 4 1/2" | BM96

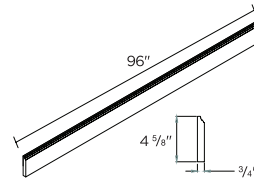

FURNITURE BASE MOULDING

Available for Beaumont & Jolie only

96 x 3/4 x 4 5/8" | FBM96

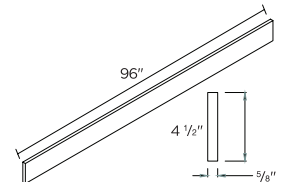

TOE-KICK

96 x 5/8 x 4 1/2" | TK96

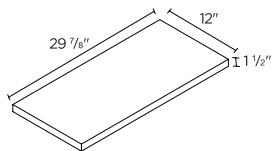

FLOATING SHELF

30 x 12 x 1 1/2" | FS3012

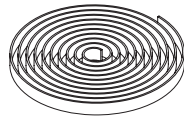

EDGE BANDING

35' roll | ET35



Base
window
seat

INTERIOR ACCESSORIES & HARDWARE

Designed to make everyday use of your kitchen a great experience, our specially designed interior accessories are made to our exacting Hugo&Borg standards. Don't forget, the Hugo&Borg range includes all the hardware and fittings you need from hinges to toe-kick clips.

INTERIOR ACCESSORIES ➤

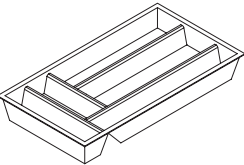

CUTLERY TRAY 15"
15 x 24" | CT15

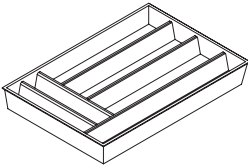

CUTLERY TRAY 18"
18 x 24" | CT18

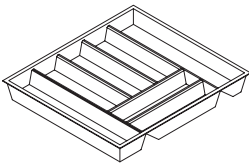

CUTLERY TRAY 24"
24 x 24" | CT24

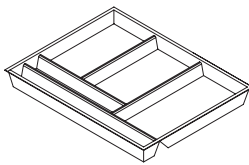

CUTLERY TRAY 30"
30 x 24" | CT30

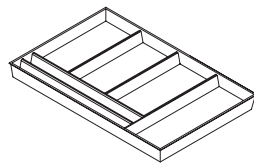

CUTLERY TRAY 36"
36 x 24" | CT36

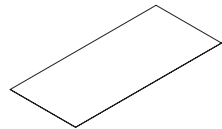

DRAWER MAT
Must be trimmed by installer
46 x 24" | DM46

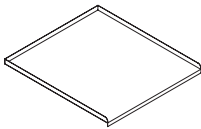

UNDER SINK MAT
30 x 24" | SBM30
36 x 24" | SBM36

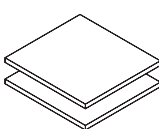

SHELVING 14"
9 x 3/4" | SHL-914
12 x 3/4" | SHL-1214
15 x 3/4" | SHL-1514
18 x 3/4" | SHL-1814
21 x 3/4" | SHL-2114
24 x 3/4" | SHL-2414
27 x 3/4" | SHL-2714
30 x 3/4" | SHL-3014
33 x 3/4" | SHL-3314
36 x 3/4" | SHL-3614

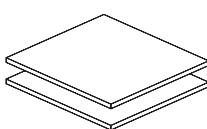

SHELVING 24"
9 x 3/4" | SHL-924
12 x 3/4" | SHL-1224
15 x 3/4" | SHL-1524
18 x 3/4" | SHL-1824
21 x 3/4" | SHL-2124
24 x 3/4" | SHL-2424
27 x 3/4" | SHL-2724
30 x 3/4" | SHL-3024
33 x 3/4" | SHL-3324
36 x 3/4" | SHL-3624

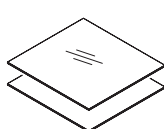

GLASS SHELVING 14"
15 x 1/4" | GSHL-1514
18 x 1/4" | GSHL-1814
30 x 1/4" | GSHL-3014
36 x 1/4" | GSHL-3614

TOUCH-UP KIT (TUK)

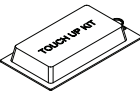

Available per collection finish. Kit includes one marker, one wax touch-up stick and one foam pad.

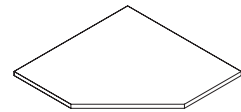

WALL CORNER SHELF 24"
24" | SHL-2424 CORNER

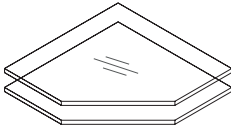

WALL CORNER GLASS SHELVES 24"
24" | GSHL-2424C
CORNER - PACK OF 2

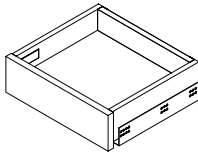

SHALLOW INNER DRAWER KIT 14"
15 x 3 3/8" | DK1514
18 x 3 3/8" | DK1814
24 x 3 3/8" | DK2414

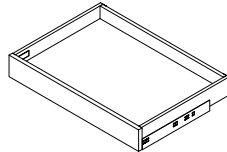

INNER DRAWER KIT 24"
12 x 3 3/8" | DK1224
15 x 3 3/8" | DK1524
18 x 3 3/8" | DK1824
21 x 3 3/8" | DK2124
24 x 3 3/8" | DK2424
27 x 3 3/8" | DK2724
30 x 3 3/8" | DK3024
33 x 3 3/8" | DK3324
36 x 3 3/8" | DK3624

HARDWARE > *Hinges available in sets of 2.*

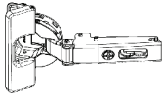

110 DEGREE HINGE

Used for standard doors
HIN110

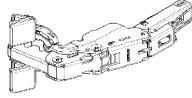

155 DEGREE HINGE

Must be used when adding
interior drawers behind
cabinet doors
HIN155

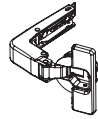

110 DEGREE BLIND CORNER HINGE

HINBC

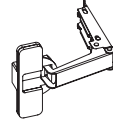

PIE CUT HINGE

HINPC

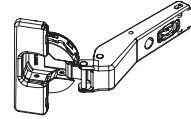

DIAGONAL CORNER WALL HINGE

HIN45

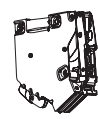

HORIZONTAL LIFT-UP HINGE

Used to create lift-up doors
HINLU



Lorette



HUGO & BORG

CABINET MAKERS

Exclusive to Lowe's

www.hugoandborg.com

Email: info@hugoandborg.com

Tel: 1.833.748.HUGO (4846)

